

PN 10/16/25 - DN 40...600

KAT-A 1030-F5-W

Product characteristics and benefits

- Resilient seated in accordance with EN 1074 (DIN 3352 - 4B)
- Face-to-face length acc. to EN 558, basic series 15 (DIN 3202, F5)
- With flange ends on both sides acc. to EN 1092-2
- Low operating torque due to plastic sliding guides on the wedge
- Maintenance-free and corrosion-resistant stem sealing
- With triple O-ring sealing
- Low wear due to wedge guiding and elongated stem bearing
- Suitable for vacuum of up to 90%
- With integrated adapter for the TELEMAR[®] stem extension

Materials

- Body: Ductile iron EN-GJS-400-15 (GGG-40)
- Bonnet: Ductile iron EN-GJS-400-15 (GGG-40)
- Wedge: Ductile iron EN-GJS-400-15 (GGG-40) encapsulated with EPDM vulcanized
- Bonnet bolts: Stainless steel A2 (DIN EN ISO 3506)
- Stem: Stainless steel 1.4057
- Stem nut: Brass

Corrosion protection

- Internally and externally epoxy coated acc. to GSK guidelines

Versions

- Standard version as described
- With rising stem (until DN 600)
- Actuator:
 - Electric
 - Prepared for electric
 - Pneumatic (until DN 300)
 - Handwheel
- PN 25 on request only

Field of application

- Underground installation
- Chamber installation
- Installation in plants

**Tests and approvals**

- Final inspection test according to EN 12266-1 (leakage rate A)
- DVGW tested and registered (PN 10/16)
- Elastomers approved acc. to W270

Accessories

- T-key
- Installation equipment
- Extension spindle
- Surface box cast iron
- Plastic base plate
- VAG SERIO[®]plus position indicator

Note

For proper installation and safe operation please follow the installation and operation instructions:
"Installation and Operating Instructions for Valves"

Field of application

DN	PN	Maximum operating pressure [bar]	Maximum operating temperature for neutral liquids [°C]
40...500	25	25	50
40...500	16	16	50
200...600	10	10	50

* Stem material will be changed from 1.4021 to 1.4057

Drawing

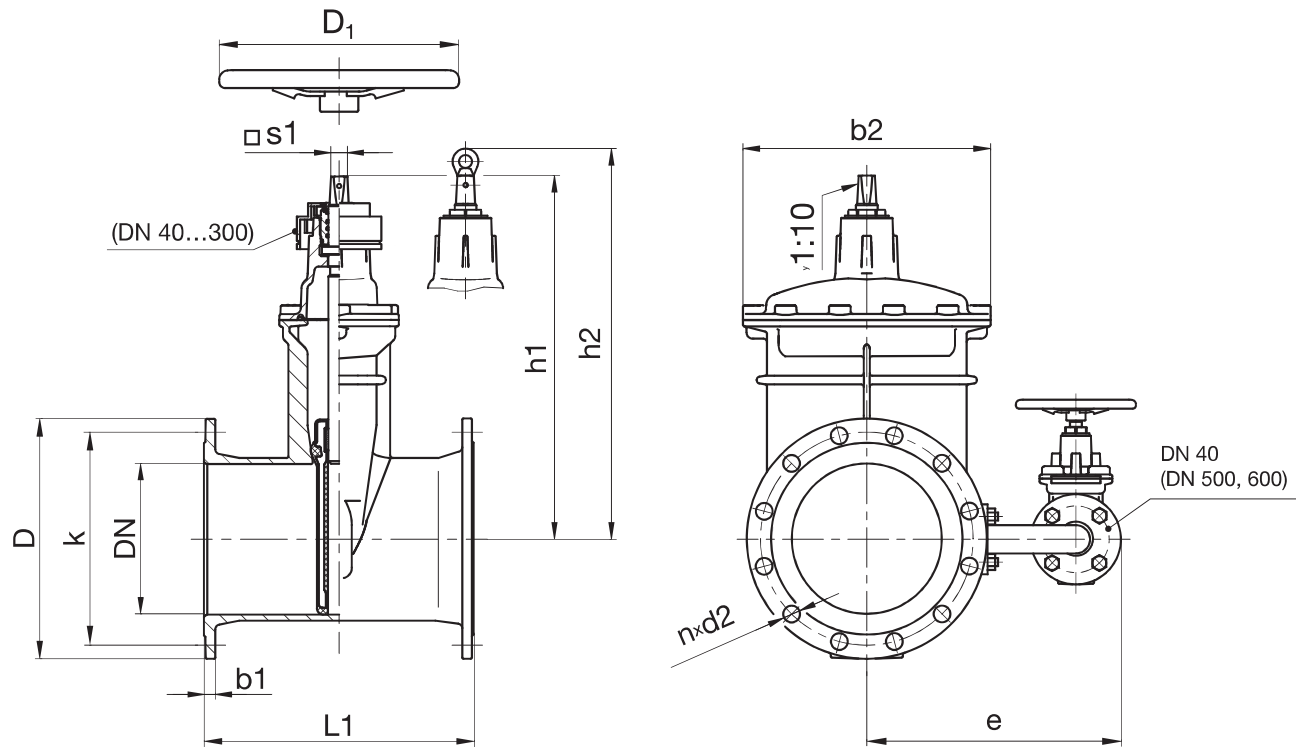

DN 600 - PN 10/16: Passage as DN 500
DN 500 and 600 with bypass DN 40

Technical data

PN 10

DN	200	250	300	350	400	500	600
D	[mm] 340	400	455	520	580	715	780
k	[mm] 295	350	400	460	515	620	725
D1	[mm] 400	500	500	500	630	630	630
L1	[mm] 400	450	500	550	600	700	800
b1	[mm] 20	22	24.5	26.5	28.5	31.5	30
b2	[mm] 330	413	472	619	619	726	726
d2	[mm] 23	23	23	23	28	28	31
e	[mm] -	-	-	-	-	580	580
h1	[mm] 493	606	670	852	936	1096	1096
h2	[mm] 537	650	714	867	956	-	-
$\square s1$	[mm] 24	27	27	27	32	32	32
No. of holes	8	12	12	16	16	20	20
Turns/stroke	34	43	51	59	50	64	64
Weight approx.	[kg] 57.30	99.00	132.30	276.00	348.00	538.00	660.00
Volume approx.	[m ³] 0.09	0.147	0.207	0.318	0.426	0.727	0.927

Technical data

PN 16

DN		40	50	65	80	100	125	150	200	250	300	350	400
D	[mm]	150	165	185	200	220	250	285	340	400	455	520	580
k	[mm]	110	125	145	160	180	210	240	295	355	410	470	525
D1	[mm]	200	200	250	250	300	300	300	400	500	500	500	630
L1	[mm]	240	250	270	280	300	325	350	400	450	500	550	600
b1	[mm]	19	19	19	19	19	19	19	20	22	24.5	26.5	28.5
b2	[mm]	121	121	206	206	206	228	252	330	413	472	619	619
d2	[mm]	19	19	19	19	19	19	23	23	28	28	28	31
h1	[mm]	226	233	273	278	310	347	386	493	606	670	852	936
h2	[mm]	-	-	-	-	-	-	-	537	650	714	867	956
□ s1	[mm]	14	14	17	17	19	19	19	24	27	27	27	32
No. of holes		4	4	4	8	8	8	8	12	12	12	16	16
Turns/stroke		12	14.5	20.5	21.5	21.5	26.5	32	34	43	51	59	50
Weight approx.	[kg]	8.70	9.70	14.50	16.90	22.50	27.80	34.70	56.90	97.50	131.80	276.00	348.00
Volume approx.	[m ³]	0.011	0.013	0.018	0.02	0.028	0.038	0.053	0.09	0.147	0.207	0.318	0.426

PN 16

DN		500	600
D	[mm]	715	780
k	[mm]	650	770
D1	[mm]	630	630
L1	[mm]	700	800
b1	[mm]	31.5	30
b2	[mm]	726	726
d2	[mm]	34	31
e	[mm]	580	580
h1	[mm]	1096	1096
□ s1	[mm]	32	32
No. of holes		20	20
Turns/stroke		64	64
Weight approx.	[kg]	538.00	660.00
Volume approx.	[m ³]	0.727	0.927

PN 25

DN		40	50	65	80	100	125	150	200	250	300	400	500
D	[mm]	150	165	185	200	235	270	300	360	425	485	620	730
k	[mm]	110	125	145	160	190	220	250	310	370	430	550	660
D1	[mm]	200	200	250	250	300	300	300	400	500	500	-	630
L1	[mm]	240	250	270	280	300	325	350	400	450	500	600	700
b1	[mm]	19	19	19	19	19	19	20	22	24.5	27.5	32	36.5
b2	[mm]	121	121	206	206	206	228	252	330	413	472	619	726
d2	[mm]	19	19	19	19	23	28	28	28	31	31	37	37
e	[mm]	-	-	-	-	-	-	-	-	-	-	-	580
h1	[mm]	226	233	273	278	310	347	386	493	606	670	936	1096
h2	[mm]	-	-	-	-	-	-	-	537	650	714	956	-
□ s1	[mm]	14	14	17	17	19	19	19	24	27	27	32	32
No. of holes		4	4	8	8	8	8	8	12	12	16	16	20
Turns/stroke		12	14.5	20.5	21.5	21.5	26.5	32	34	43	51	50	64
Weight approx.	[kg]	8.70	9.70	14.50	16.90	22.50	27.80	34.70	56.90	110.50	131.80	337.00	538.00
Volume approx.	[m ³]	0.011	0.013	0.018	0.02	0.028	0.038	0.053	0.09	0.147	0.207	0.426	0.727